

\* a PART OF ITEM 1

Figure 249. Fifth Wheel Assembly, Basic (Sheet 1 of 2).

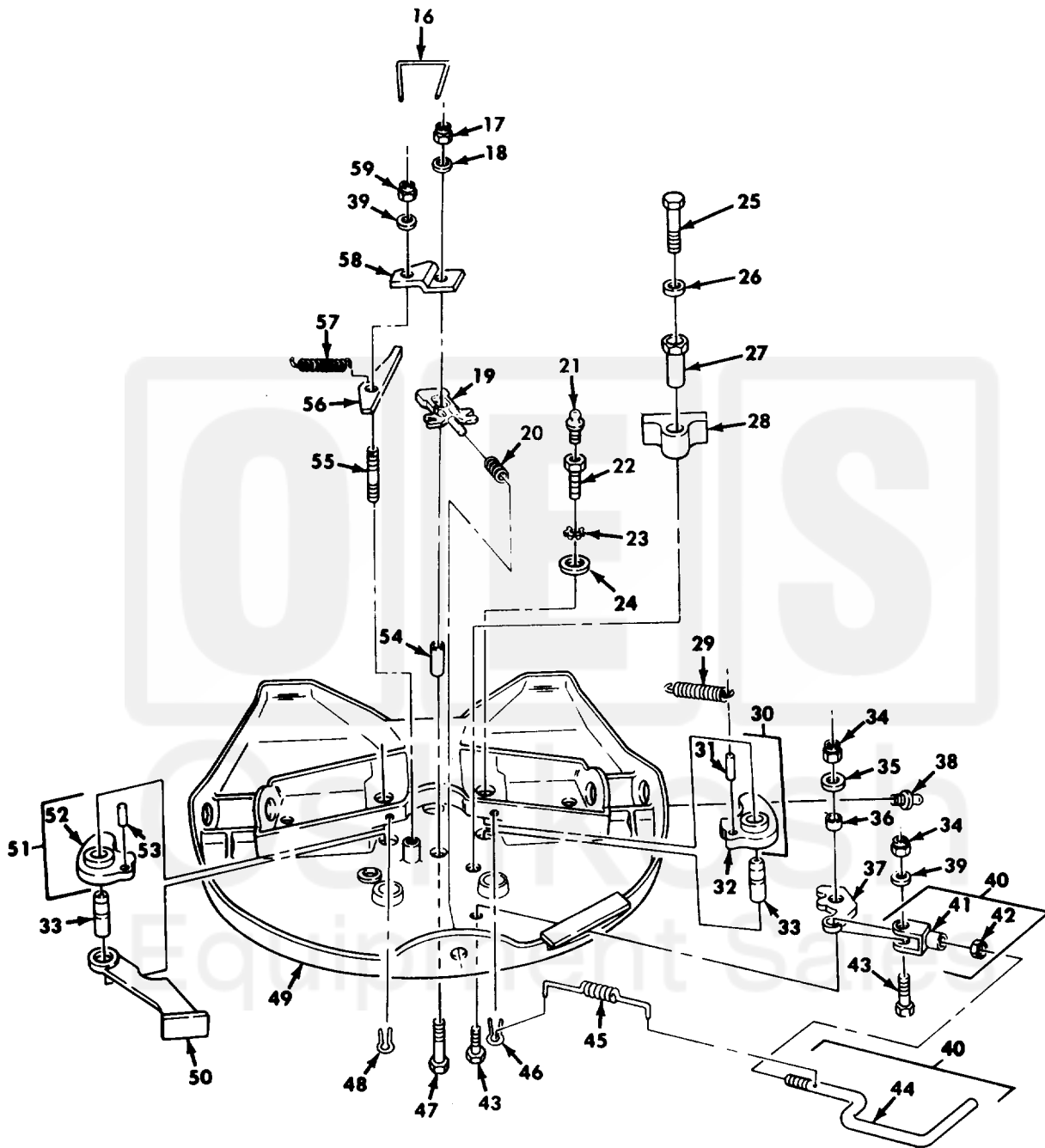

Figure 249. Fifth Wheel Assembly, Basic (Sheet 2 of 2).

ITEM NO	SMR CODE	CAGEC	PART NUMBER	DESCRIPTION AND USABLE ON CODES(UOC)	QTY
GROUP 1506 FIFTH WHEEL					
FIG. 249 FIFTH WHEEL ASSEMBLY BASIC					
1	PAOFF	19207	11669413-1	FIFTH WHEEL ASSEMBL UOC: 634, 635	1
2	XAFZZ	19207	12300586	.WALKING BEAM UOC: 634, 635	1
3	PAFZZ	96906	MS90728-189	.SCREW, CAP, HEXAGON H UOC: 634, 635	4
4	PAFZZ	19207	12300589	.WASHER, FLAT UOC: 634, 635	4
5	PFOZZ	19207	12300579	.WEDGE, LEVELING UOC: 634, 635	2
6	PPFZZ	19207	12300739	.BASE PLATE ASSY UOC: 634, 635	1
7	PPFZZ	19207	12300738	.BEARING, SLEEVE UOC: 634, 635	4
8	PAFZZ	19207	12300989	.SPRING, HELICAL, COMP UOC: 634, 635	1
9	PAFZZ	19207	12300990	.SPRING, HELICAL, COMP UOC: 634, 635	1
10	PAFZZ	19207	12301434	.PIN, STRAIGHT, HEADLE UOC: 634, 635	2
11	PAFZZ	19207	12301433	.PIN, CLIP UOC: 634, 635	2
12	PAFZZ	14371	59-002134	.BUSHING, PIN MOUNT UOC: 634, 635	2
13	PAFZZ	96906	MS15003-4	.FITTING, LUBRICATION UOC: 634, 635	2
14	PFOZZ	19207	12300582	.SHAFT, WALKING BEAM UOC: 634, 635	1
15	PAOZZ	19207	12300585	.PIN, GROOVED, HEADLES UOC: 634, 635	2
16	PAFZZ	96906	MS20995F91-8	WIRE, NONELECTRICAL	1
17	PAFZZ	96906	MS21045-10	NUT, SELF-LOCKING, HE PART OF KIT P/N 59-003128	1
18	PAFZZ	14371	08-201941	WASHER, FLAT UOC: 634, 635	1
19	PPFZZ	19207	12300580	RACK, FIFTH WHEEL PART OF KIT P/N 59- 003128 UOC: 634, 635	1
20	PAFZZ	19207	12300626	SPRING, HELICAL COMP PART OF KIT P/N 59-003128 UOC: 634, 635	1
21	PAFZZ	96906	MS15003-6	FITTING, LUBRICATION UOC: 614, 620, 621, 622, 623, 624, 625, 626 627, 628, 629, 630, 631, 632, 633, 634, 635, 636	2
22	PAFZZ	14371	59-001661	FITTING, LUBRICATION UOC: 634, 635	2
23	PAFZZ	96906	MS35335-40	WASHER, LOCK	2